

PARTS LISTING / LISTE DES PIÈCES

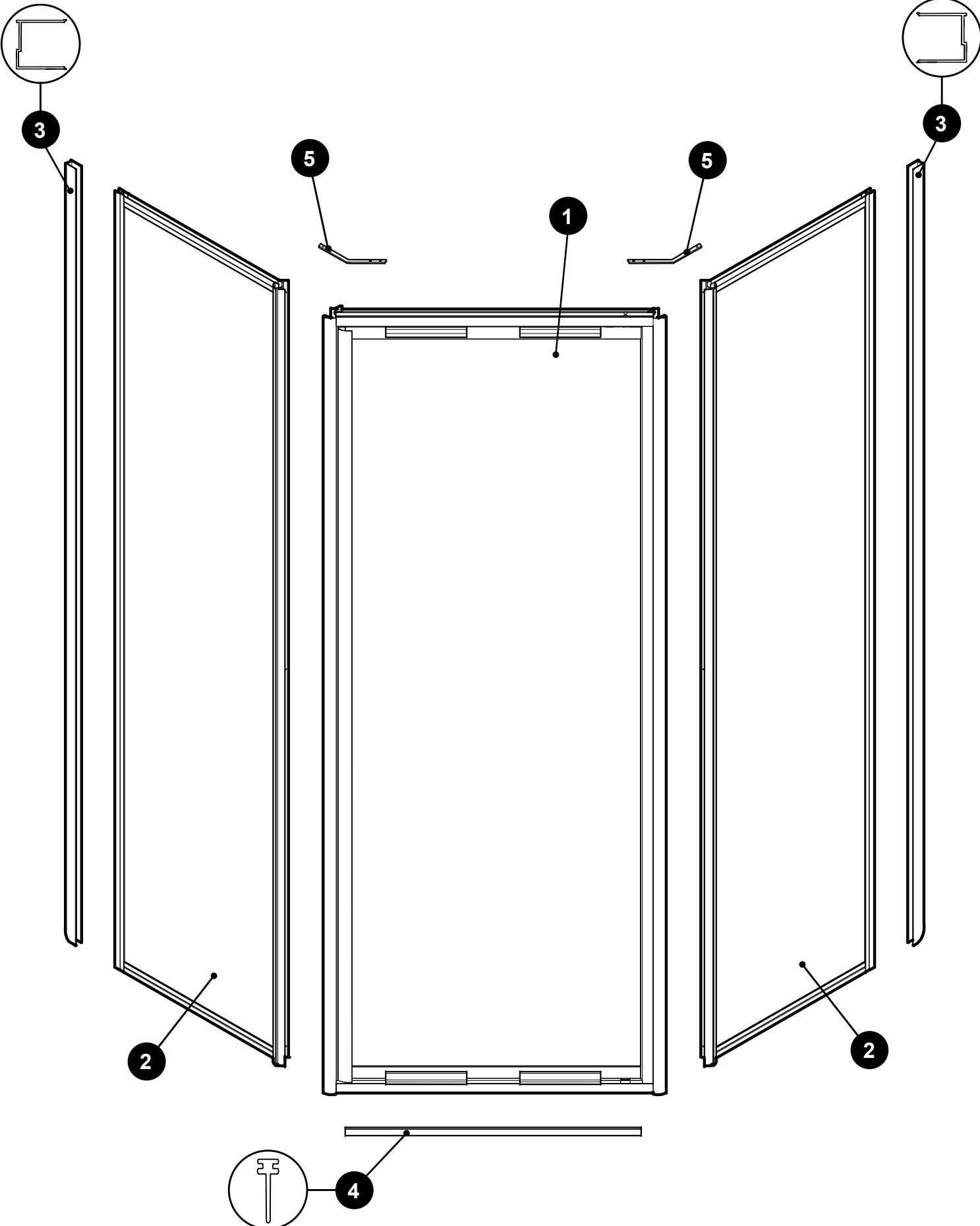

PARTS LISTING / LISTE DES PIÈCES

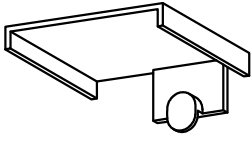
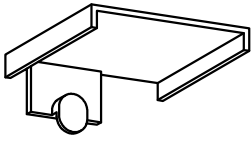

6

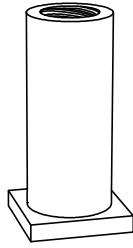

7

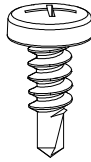

8

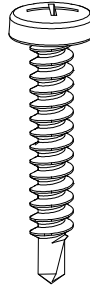

9



10



11



12

| ITEM | FLEURCO PART# | PARTS AND HARDWARE / PIÈCES ET QUINCAILLERIE | QTY |
|------|-----------------|---|-----|
| 1 | | FRAMED DOOR PANEL / PANNEAU DE PORTE | 2 |
| 2 | | SIDE PANEL / PANNEAU LATÉRAL | 2 |
| 3 | FNAS-WJAMB-XX | WALL JAMB / JAMBAGE MURAL | 2 |
| 4 | M2-GSK-32 | SPLASH GUARD / JOINT ANTI-ÉCLABOUSSURE | 2 |
| 5 | FNAS-135BRACKET | ANGLE BRACKET / ANGLE DE RENFORT | 2 |
| 6 | | WALL JAMB COVER / COUVRE JAMBAGE MURAL | 2 |
| 7 | | WALL JAMB ATTACHMENT / FIXATION DU JAMBAGE MURAL | 4 |
| 8 | | PAN SELF DRILLING SCREW #8 - 3/8" / VIS PAN AUTO-PERÇANTE #8 - 3/8" | 8 |
| 9 | | SELF DRILLING SCREW #8 x 1-1/2" LG / VIS AUTO-PERÇANTE #8 x 1-1/2" LG | 6 |
| 10 | | PAN HEAD SCREW #8 - 1/2" / VIS PAN #8 - 1/2" | 6 |
| 11 | | SCREW CAP / CAPUCHON COUVRE-VIS | 6 |
| 12 | | BACK SCREW CAP / L'ARRIÈRE DU CAPUCHON COUVRE-VIS | 6 |