

PARTS LISTING / LISTE DES PIÈCES

PJC3636, PJC3838

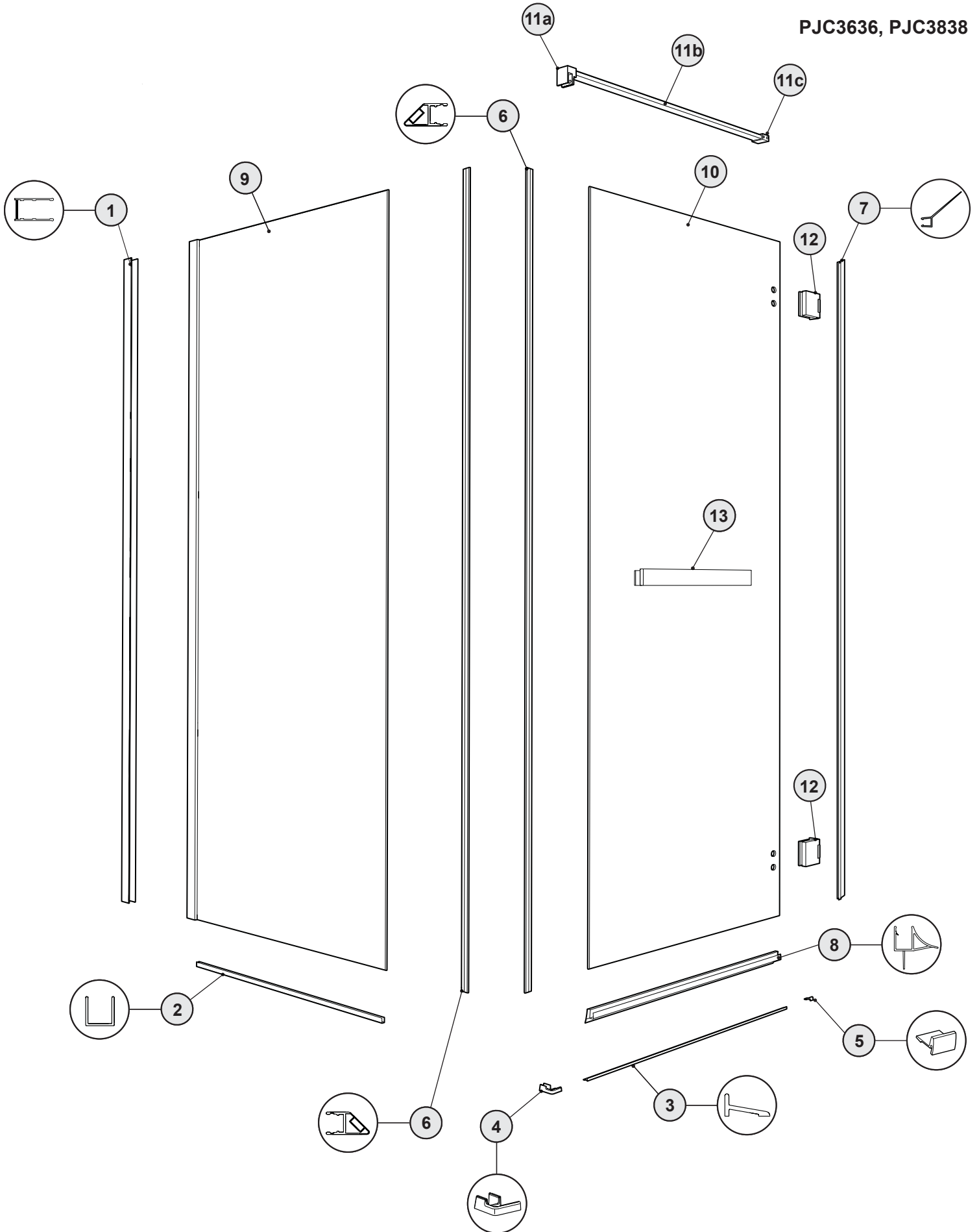

PARTS LISTING / LISTE DES PIÈCES

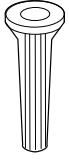

14



15



16



17



18

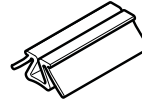

19



20



21

ITEM	FLEURCO CODE	PARTS LISTING / LISTE DES PIÈCES	QTY
1	PLAT-WJAMB-33-79	WALL JAMB / JAMBAGE	1
	++15419-80		
2	NA/PJ-UCHANNEL-42-XX	U-CHANNEL / PROFILÉ EN «U»	1
3	PLAT-THRESH-33-72	THRESHOLD / SEUIL	1
	++15405		
4	PLRCLP-(L)(R)-XX	CORNER THRESHOLD ANCHOR / ANCRAGE DU SEUIL DE COIN	1
5	PENDCAP-XX	THRESHOLD ANCHOR / ANCRAGE DU SEUIL	1
6	MAGNET-EA-SET-75	MAGNETIC DOOR GASKET SET / ENSEMBLE DE JOINTS MAGNÉTIQUES DE PORTE	1
7	COEX312	SIDE GASKET / JOINT LATÉRAL	1
8	COEX-297	BOTTOM DOOR GASKET / JOINT INFÉRIEUR DE LA PORTE	1
9		RETURN PANEL / PANNEAU DE RETOUR	1
10		DOOR PANEL / PANNEAU DE PORTE	1
11a	PJC-BRACKET-RP-XX	GLASS MOUNT BRACKET / SUPPORT DE VERRE	1
11b	PJ-BAR-XX-58	SUPPORT BAR / BARRE DE SUPPORT	1
	LAVBAR33-70		
11c	PJ-BRACKET-XX	WALL MOUNT BRACKET / SUPPORT MURAL	1
	LAVBRACKET-33		
12	HINGEXPJ-WM	HINGE / CHARNIÈRE	2
13	PJC-TOWELBAR22-XX	TOWEL BAR / PORTE SERVIETTE	1
14		WALL PLUGS / CHEVILLES	4
15		PAN SELF-DRILLING SCREW / VIS PAN AUTO-PERÇANTE # 8 (1 1/4")	3
16		PAN SELF-DRILLING SCREW / VIS PAN AUTO-PERÇANTE # 8 (3/8")	3
17		BACK SCREW CAP / L'ARRIÈRE DU CAPUCHON COUVRE-VIS	4
18		SCREW CAP / CAPUCHON COUVRE-VIS	4
19	PV-5681	2" SPACING BLOCK / BLOC ESPACEUR 2"	2
20		CLEAR SETTING BLOCK (1/8") / BLOC NIVEAU TRANSPARENT (1/8")	2
21		CLEAR SETTING BLOCK (1/16") / BLOC NIVEAU TRANSPARENT (1/16")	2

LEGEND / LÉGENDE

XX = FINISH/FINI (11, 25, 33)

** = LENGTH / LONGUEUR (54, 60, 79, 86 ETC)

++ = CODE / CODE (AC, ABN)

(L)(R) = LEFT OR RIGHT / GAUCHE OU DROITE