

TOOLS REQUIRED / OUTILS REQUIS

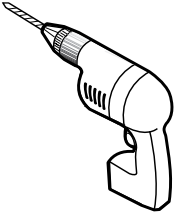

DRILL
PERCEUSE

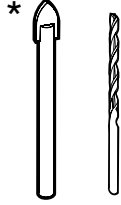

1/4" & 1/8" DRILL BITS
MÈCHE 1/4" & 1/8"



LONG NOSE LOCKING PLIERS (X3)
PINCE SERRE ÉTAU (X3)



SCREWDRIVER
TOURNEVIS



PENCIL
CRAYON

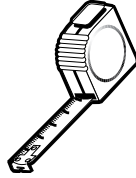

TAPE MEASURE
RUBAN À MESURER

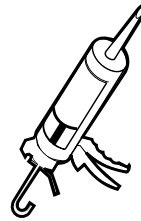

SILICONE
SCCELLANT

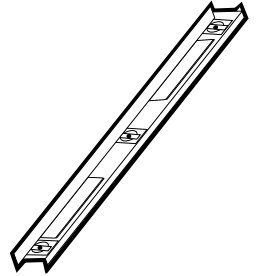

LEVEL
NIVEAU

* Use a 1/4" drill bit for ceramic when drilling into ceramic tiles

* Utiliser une mèche de 1/4" destiné à céramique lors du perçage des tuiles en céramique.

POSSIBLE CONFIGURATIONS / CONFIGURATIONS POSSIBLES

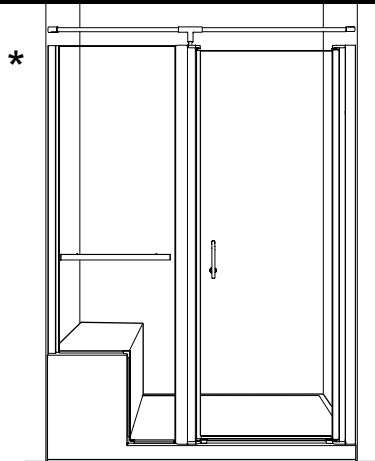

* This configuration is illustrated in this manual.

* Cette configuration est illustrée dans ce manuel.

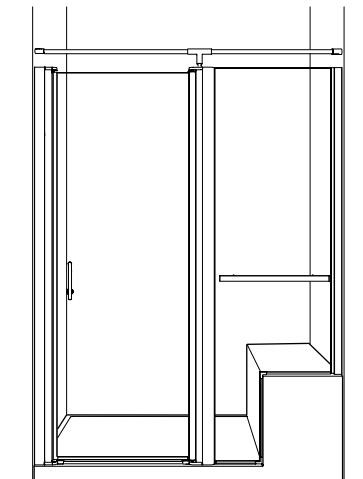
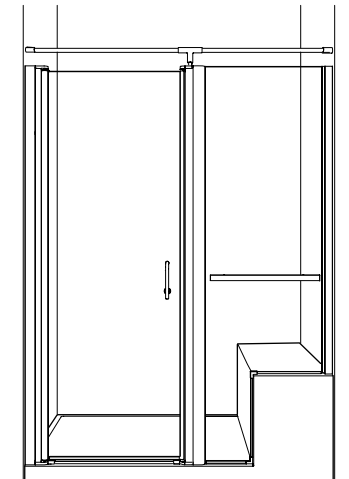
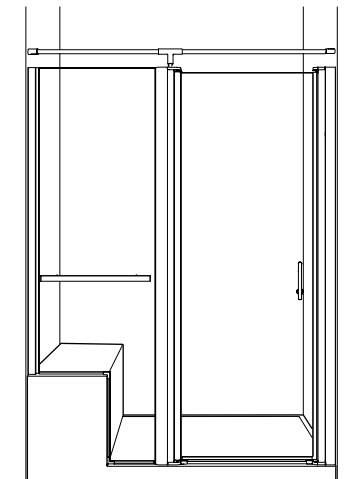

PARTS LISTING / LISTE DES PIÈCES

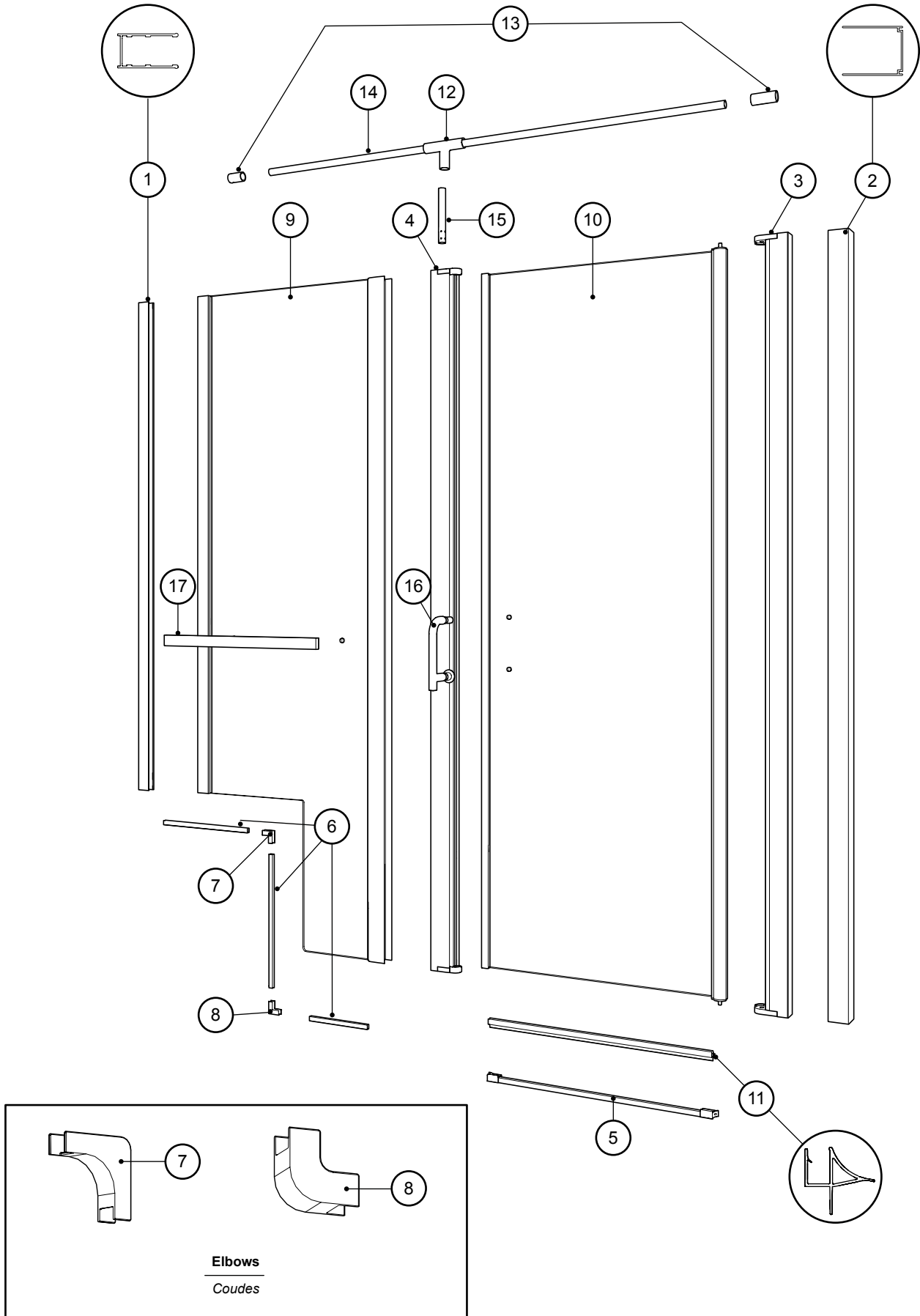

PARTS LISTING / LISTE DES PIÈCES

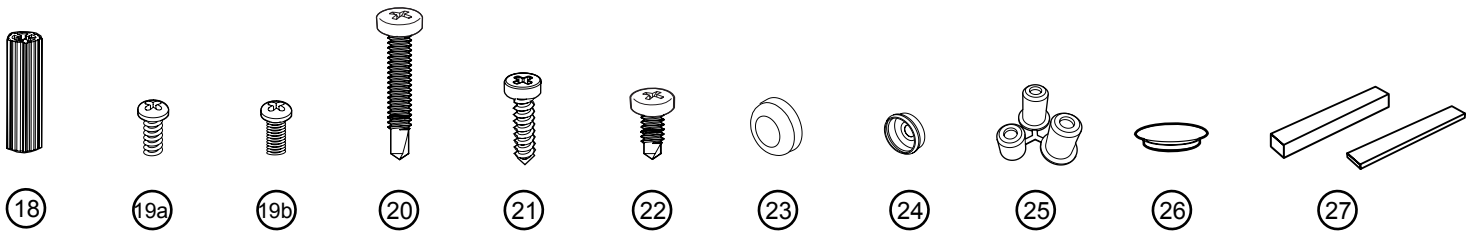

ITEM	PARTS AND HARDWARE / PIÈCES ET QUINCAILLERIE	QTY
1	WALL JAMB FOR FIXED PANEL (SHORTER) / JAMBAGE POUR LE PANNEAU FIXE (COURT)	1
2	WALL JAMB / JAMBAGE	1
3	PIVOT EXPANDER / EXTENSEUR À PIVOT	1
4	MAGNETIC EXPANDER / EXTENSEUR MAGNÉTIQUE	1
5	THRESHOLD / SEUIL	1
6	U-CHANNEL FOR FIXED PANEL (SHORT, MEDIUM, LONG) PROFILÉ EN "U" POUR LE PANNEAU FIXE (COURT, MI-LONG, LONG)	4
7	TOP ELBOW / COUDE SUPÉRIEUR	1
8	BOTTOM ELBOW / COUDE INFÉRIEUR	1
9	FIXED PANEL / PANNEAU FIXE	1
10	DOOR PANEL / PANNEAU DE PORTE	1
11	BOTTOM DOOR GASKET / JOINT INFÉRIEUR DE LA PORTE	1
12	HORIZONTAL SUPPORT BAR / BARRE DE SUPPORT HORIZONTALE	1
13	WALL MOUNT BRACKET / SUPPORT MURAL	2
14	"T" CONNECTOR / CONNECTEUR "T"	1
15	VERTICAL MID SUPPORT BAR (SHORTER) / BARRE DE SUPPORT VERTICALE DU MILIEU (COURT)	1
16	DOOR HANDLE / POIGNÉE DE LA PORTE	1
17	TOWEL BAR / BARRE À SERVIETTE	1
18	WALL PLUG / CHEVILLE	10
19a	SUPPORT BAR SCREW (FOR MEDIUM HOLE) / VIS POUR LA BARRE DE SUPPORT (POUR TROU MEDIUM)	2
19b	SUPPORT BAR SCREW (FOR SMALL HOLE) / VIS POUR LA BARRE DE SUPPORT (POUR PETIT TROU)	2
20	SELF-DRILLING WALL SCREW #8 - 1 1/4" / VIS MURAL AUTO-PERÇANTE #8 - 1 1/4"	9
21	SCREW WITH WASHER / VIS AVEC RONDELLE	1
22	SELF DRILLING PANHEAD SCREWS #8 - 3/8" / VIS À TÊTE PAN AUTO-PERÇANTE #8 - 3/8"	9
23	SCREW CAP / CAPUCHON COUVRE-VIS	9
24	BACK SCREW CAP / L'ARRIÈRE DU CAPUCHON COUVRE-VIS	9
25	PIVOT SLEEVE SET / ENSEMBLE MANCHON PIVOTANT	1
26	COVER / CAPUCHON	1
27	CLEAR SETTING BLOCKS / BLOCS À NIVEAU TRANSPARENTS	4