

**TOOLS REQUIRED
OUTILS REQUIS**

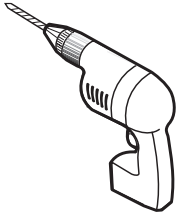

DRILL
PERCEUSE



1/4" & 1/8" DRILL BITS
MÈCHE 1/4" & 1/8"

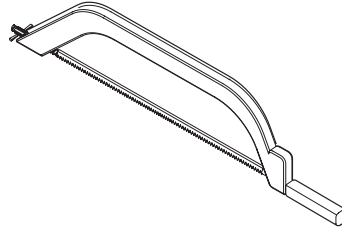

HACKSAW
SCIE À MÉTAUX

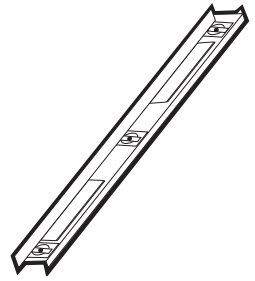

LEVEL
NIVEAU



PENCIL
CRAYON

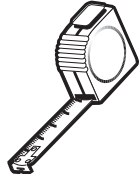

TAPE MEASURE
RUBAN À MESURER



SCREWDRIVER
TOURNEVIS

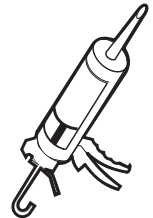

SILICONE
SCÉLLANT

*** Use a 1/4" drill bit for ceramic when drilling into ceramic tiles**
*** Utiliser une mèche à céramique de 1/4" lors du perçage des tuiles en céramique.**

**POSSIBLE CONFIGURATIONS
CONFIGURATIONS POSSIBLES**

*** SHOWER / DOUCHE**

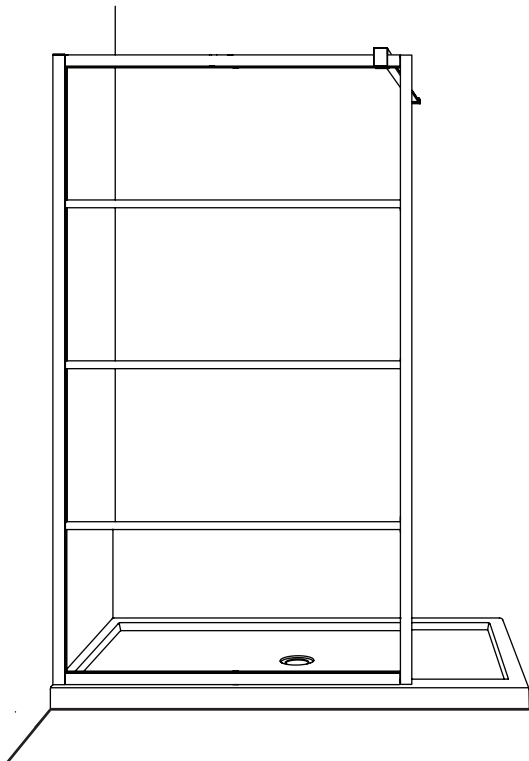

TUB / BAIGNOIRE

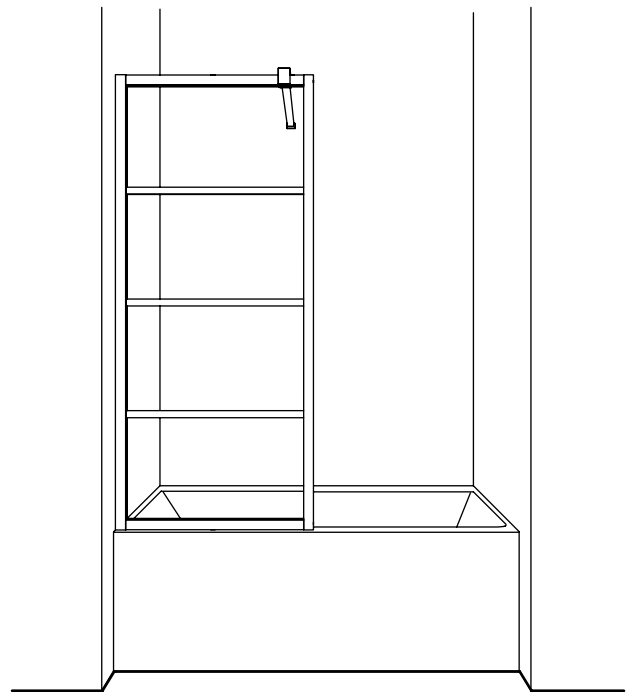

*** This configuration is illustrated in this manual.**

*** Cette configuration est illustrée dans ce manuel.**

PARTS AND HARDWARE LISTING
LISTE DES PIÈCES ET QUINCAILLERIE

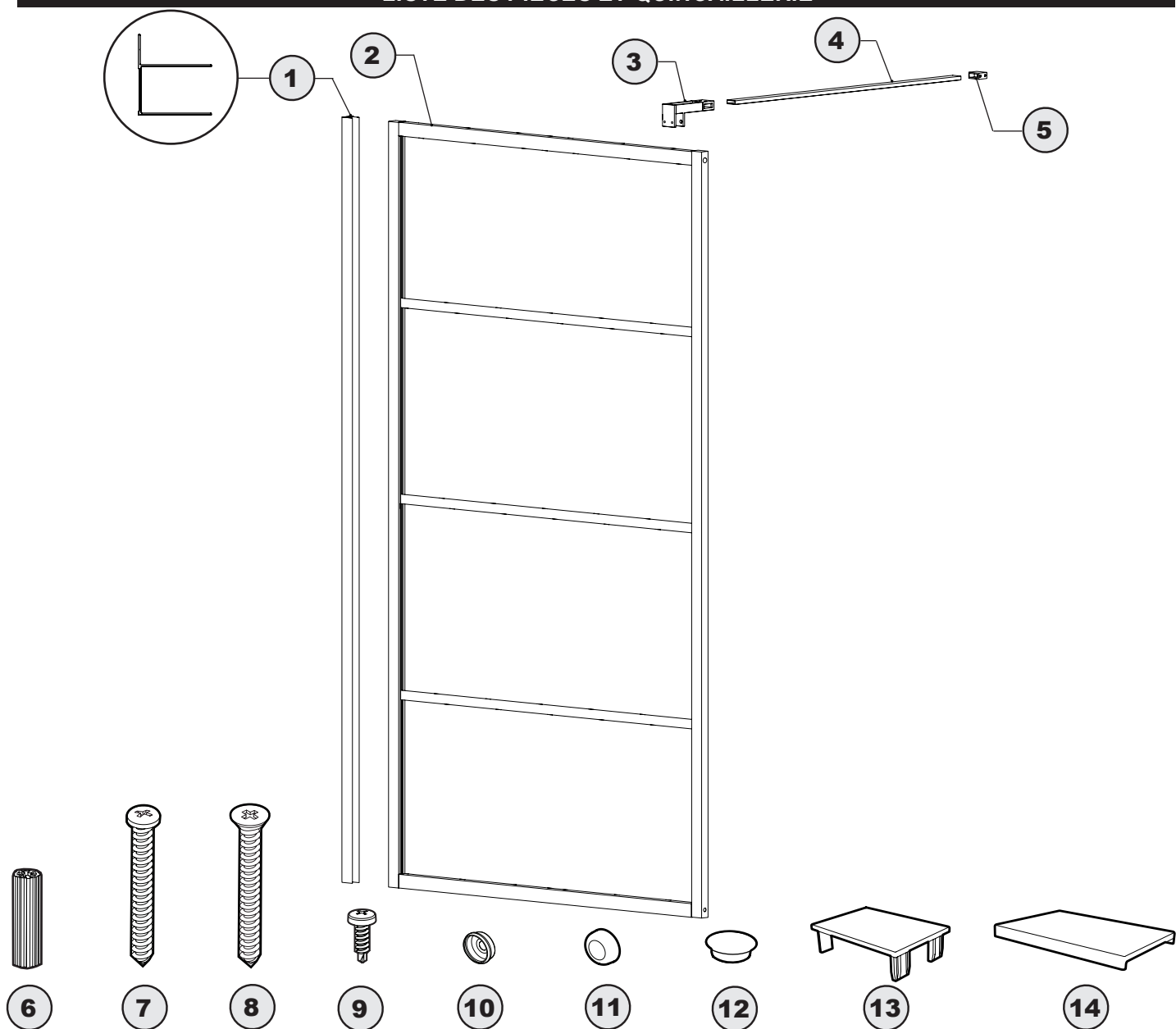

ITEM	FLEURCO CODE	PARTS AND HARDWARE / PIÈCES ET QUINCAILLERIE	QTY
1	LA-WJAMB-33-79	WALL JAMB / JAMBAGE	1
2		FIXED PANEL / PANNEAU FIXE	1
3	LAV-BRACKET-S-33	GLASS MOUNT BRACKET / SUPPORT DE VERRE	1
4	LAVBAR-33-70	SUPPORT BAR / BARRE DE SUPPORT	1
5	LAVBRACKET-33	WALL MOUNT BRACKET / SUPPORT MURAL	1
6		WALL PLUG / CHEVILLE	4
7		FLAT HEAD SCREW / VIS À TÊTE PLATE	1
8		PAN HEAD SCREW / VIS À TÊTE CYLINDRIQUE	3
9		PAN SELF-DRILLING SCREW / VIS PAN AUTO-PERÇANTE	3
10		BACK SCREW CAP / L'ARRIÈRE DU CAPUCHON COUVRE-VIS	6
11		SCREW CAP / CAPUCHON COUVRE-VIS	6
12		SCREW CAP / CAPUCHON COUVRE-VIS	2
13	LA-RP-CAP-33-79	FRAME CAP / CAPUCHON DU CADRE	1
14	LA-WJCAP-33	WALL JAMB CAP / CAPUCHON DU JAMBAGE	1

PARTS AND HARDWARE LISTING
LISTE DES PIÈCES ET QUINCAILLERIE

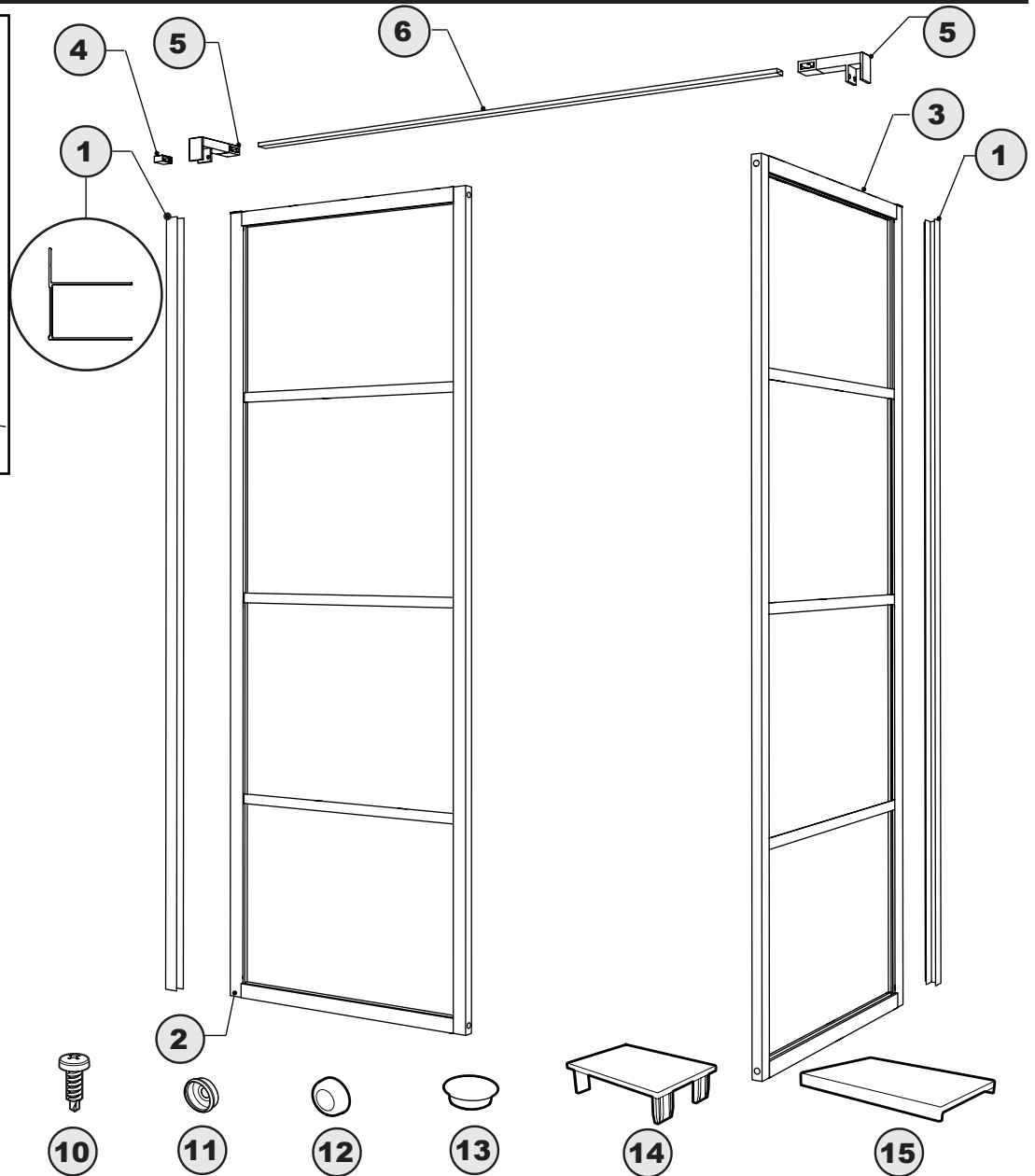
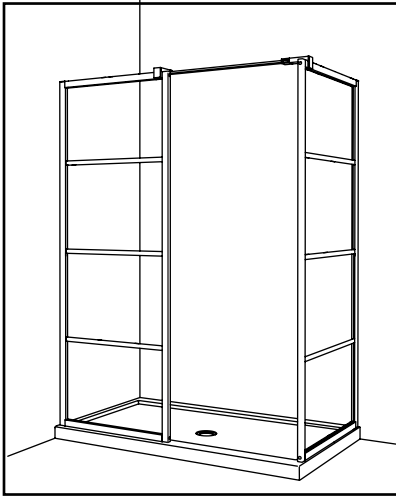

ITEM	FLEURCO CODE	PARTS AND HARDWARE / PIÈCES ET QUINCAILLERIE	QTY
1	LA-WJAMB-33-79	WALL JAMB / JAMBAGE	2
2		FIXED PANEL / PANNEAU FIXE	1
3		RETURN PANEL / PANNEAU DE RETOUR	1
4	LAVBRACKET-33	WALL MOUNT BRACKET / SUPPORT MURAL	1
5	LAV-BRACKET-S-33	GLASS MOUNT BRACKET / SUPPORT DE VERRE	2
6	LAVBAR-33-70	SUPPORT BAR / BARRE DE SUPPORT	1
7		WALL PLUG / CHEVILLE	7
8		PAN HEAD SCREW / VIS À TÊTE CYLINDRIQUE	6
9		FLAT HEAD SCREW / VIS À TÊTE PLATE	1
10		PAN SELF-DRILLING SCREW / VIS PAN AUTO-PERÇANTE	6
11		BACK SCREW CAP / CAPUCHON COUVRE-VIS ARRIERE	6
12		SCREW CAP / CAPUCHON COUVRE-VIS	6
13		SCREW CAP / CAPUCHON COUVRE-VIS	4
14	LA-RP-CAP-33-79	FRAME CAP / CAPUCHON DU CADRE	4
15	LA-WJCAP-33	WALL JAMB CAP / CAPUCHON DU JAMBAGE	2

PARTS AND HARDWARE LISTING
LISTE DES PIÈCES ET QUINCAILLERIE

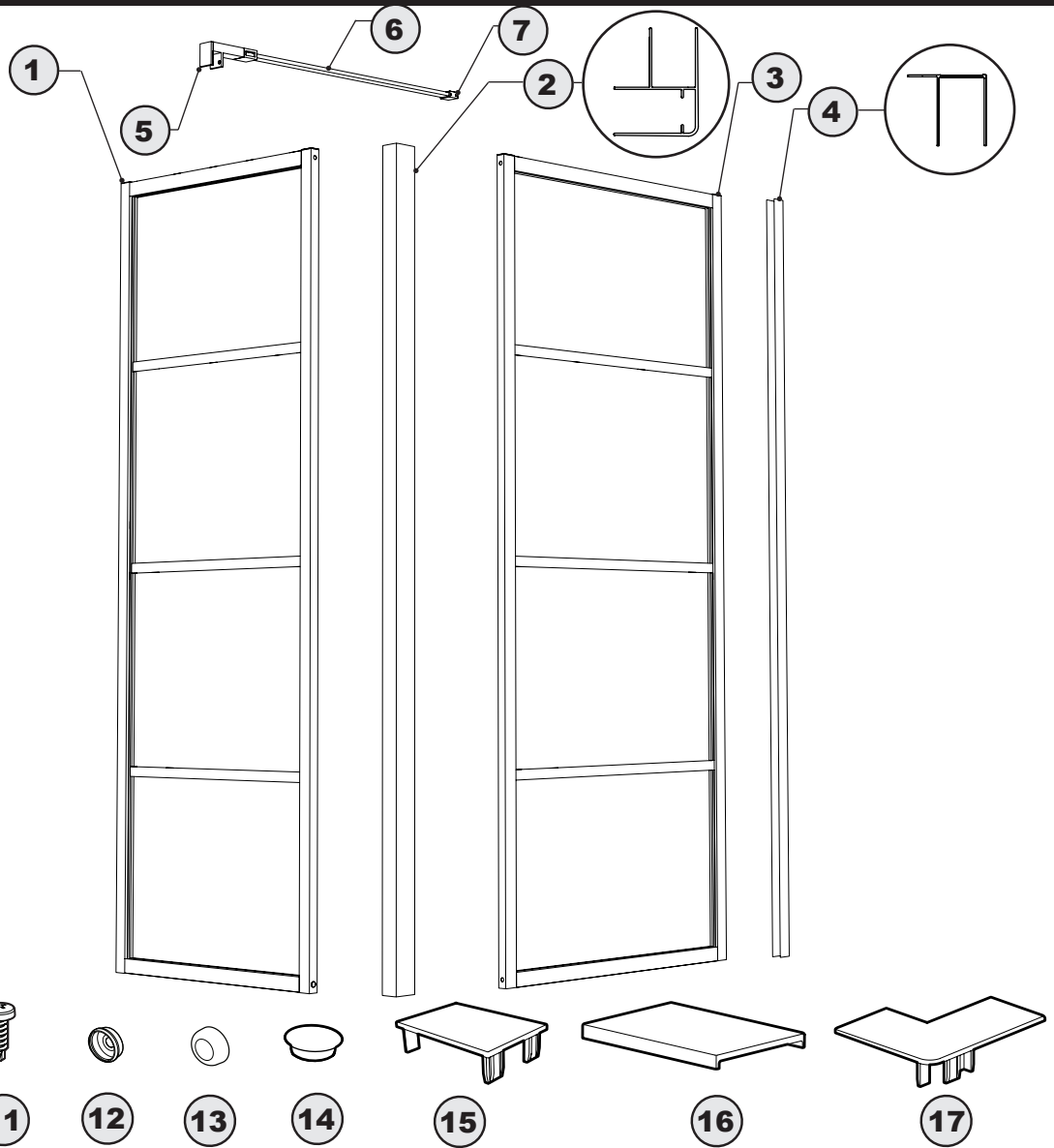
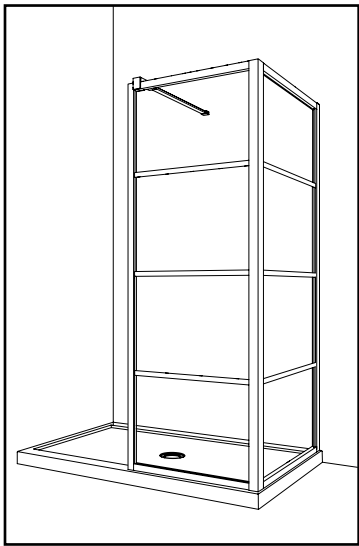

ITEM	PARTS AND HARDWARE / PIÈCES ET QUINCAILLERIE	QTY
1	FIXED PANEL / PANNEAU FIXE	2
2	CORNER JAMB / JAMBAGE DU COIN	1
3	RETURN PANEL / PANNEAU DE RETOUR	1
4	WALL JAMB / JAMBAGE	1
5	GLASS MOUNT BRACKET / SUPPORT DE VERRE	2
6	SUPPORT BAR / BARRE DE SUPPORT	1
7	WALL MOUNT BRACKET / SUPPORT MURAL	1
8	WALL PLUG / CHEVILLE	4
9	PAN HEAD SCREW / VIS À TÊTE CYLINDRIQUE	3
10	FLAT HEAD SCREW / VIS À TÊTE PLATE	1
11	PAN SELF-DRILLING SCREW / VIS PAN AUTO-PERÇANTE	3
12	BACK SCREW CAP / CAPUCHON COUVRE-VIS ARRIERE	9
13	SCREW CAP / CAPUCHON COUVRE-VIS	9
14	SCREW CAP / CAPUCHON COUVRE-VIS	2
15	FRAME CAP / CAPUCHON DU CADRE	2
16	WALL JAMB CAP / CAPUCHON DU JAMBAGE	1
17	CORNER JAMB CAP / CAPUCHON DU JAMBAGE DU COIN	1