

TOOLS REQUIRED / OUTILS REQUIS

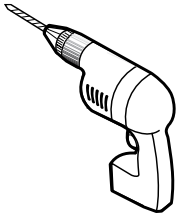

DRILL
PERCEUSE

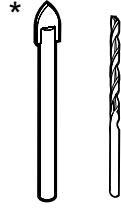

1/4" & 1/8" DRILL BITS
MÈCHES 1/4" & 1/8"



SCREWDRIVER
TOURNEVIS



SCREWDRIVER
TOURNEVIS



PENCIL
CRAYON

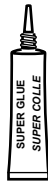

SUPER GLUE
COLLE FORTE



BLOCK
BLOC

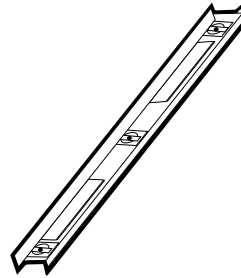

LEVEL
NIVEAU

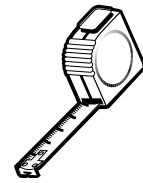

TAPE MEASURE
RUBAN À MESURER

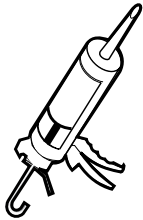

SILICONE
SCÉLANT

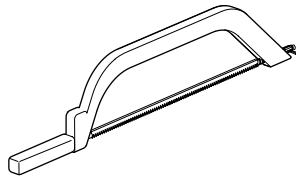

HACKSAW
SCIE À MÉTAUX

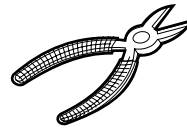

CUTTING PLIERS
PINCE COUPANTE

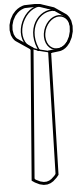

MALLET
MAILLET

* Use a 1/4" drill bit when drilling into ceramic tiles

* Utiliser une mèche de 1/4" pour percer des tuiles en céramique.

TOOLS REQUIRED TO CUT THE RUNNING RAIL OUTILS REQUIS POUR COUPER LA BARRE DE ROULEMENT

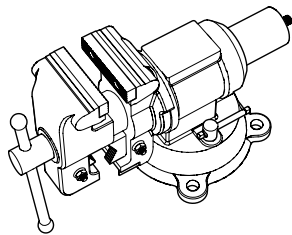
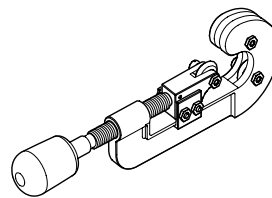

TABLE VISE
ÉTAU DE TABLE



**TUBE CUTTER WITH CUTTER WHEEL FOR STAINLESS
STEEL (TUBE DIAMETER : 1" / 25.4mm)**

COUPE-TUBE AVEC UNE ROUE COUPANTE POUR ACIER
INOXYDABLE (DIAMÈTRE DU TUBE: 1" / 25.4mm)

PARTS LISTING / LISTE DES PIÈCES

POSSIBLE CONFIGURATIONS / CONFIGURATIONS POSSIBLES

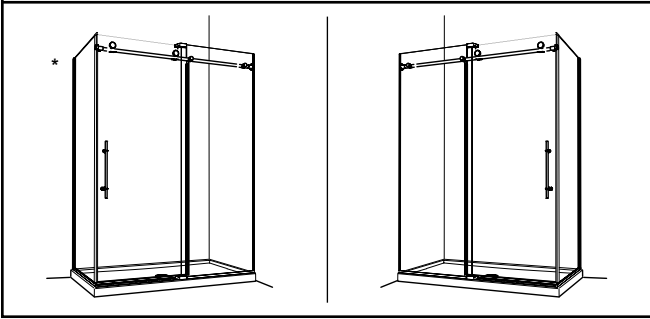

* This configuration illustrated in this manual.
* Cette configuration est illustrée dans ce manuel.

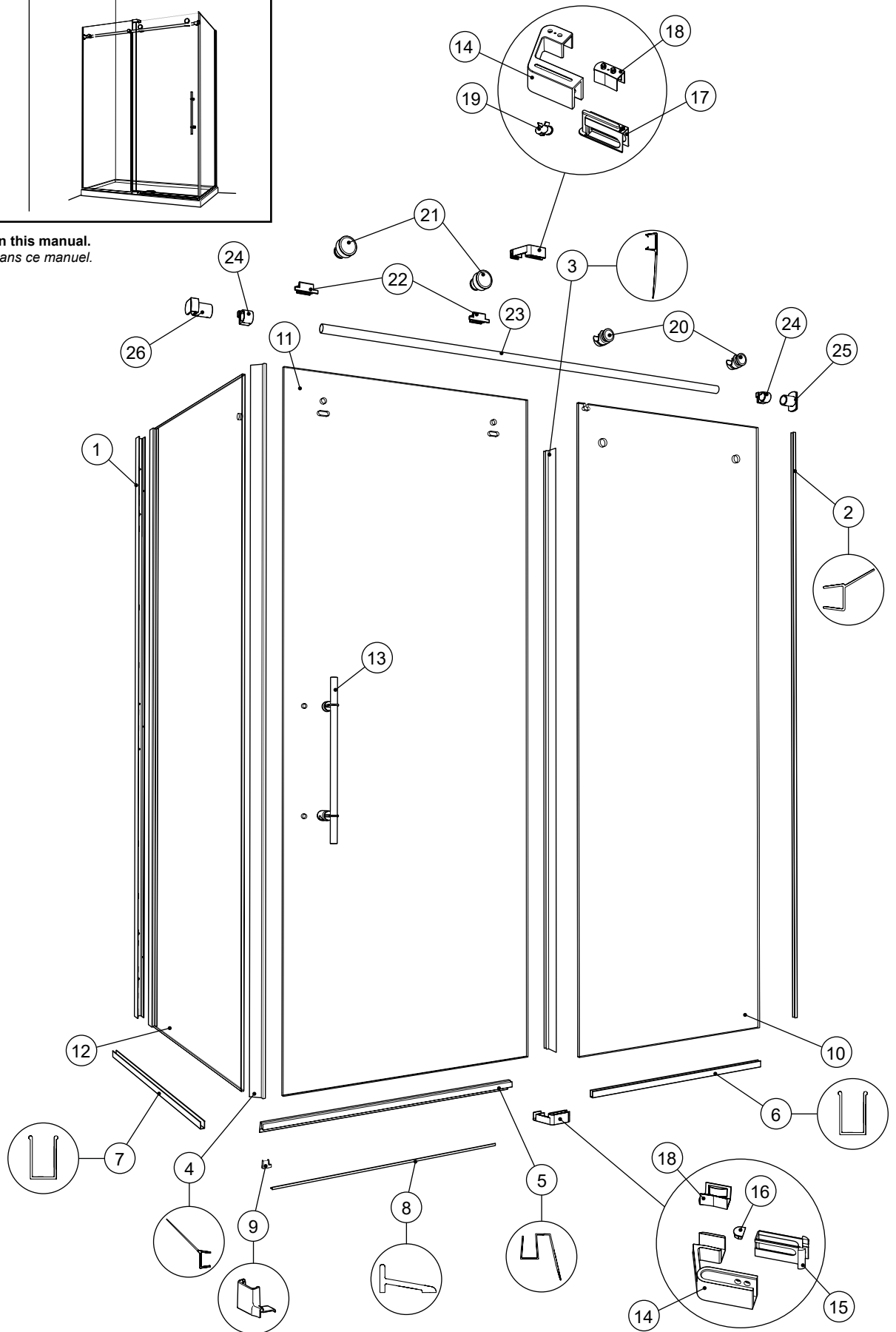

PARTS LISTING / LISTE DES PIÈCES

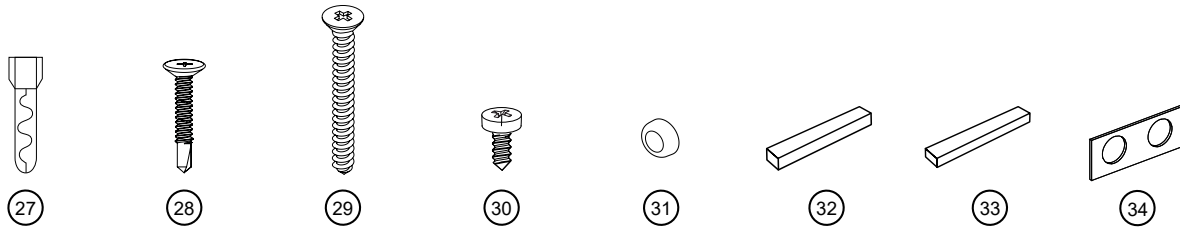

ITEM	PARTS AND HARDWARE / PIÈCES ET QUINCAILLERIE	QTY
1	WALL JAMB / JAMBAGE	1
2	SIDE GASKET (COEX K120) / JOINT DE CÔTÉ (COEX K120)	1
3	MID GASKET (COEX K310) / JOINT LATÉRAL (COEX K310)	1
4	DOOR CLOSING GASKET (COEX 309) / JOINT FERMETURE DE PORTE (COEX 309)	1
5	BOTTOM DOOR GASKET / JOINT INFÉRIEUR DE LA PORTE	1
6	FIXED PANEL U-CHANNEL / PROFILÉ EN «U» POUR PANNEAU FIXE	1
7	RETURN PANEL U-CHANNEL / PROFILÉ EN «U» POUR PANNEAU DE RETOUR	1
8	THRESHOLD / SEUIL	1
9	U-CHANNEL CAP / CAPUCHON DU PROFILÉ EN «U»	1
10	FIXED PANEL / PANNEAU FIXE	1
11	DOOR PANEL / PANNEAU DE PORTE	1
12	RETURN PANEL / PANNEAU DE RETOUR	1
13	HANDLE / POIGNÉE	1
14	GUIDE / GUIDE	2
15	BOTTOM SLEEVE / GAINÉ PROTECTRICE INFÉRIEURE	1
16	GUIDE CAP / CAPUCHON DU GUIDE	1
17	TOP SLEEVE / GAINÉ PROTECTRICE SUPÉRIEURE	1
18	PLASTIC GUIDE / GUIDE EN PLASTIQUE	2
19	SCREW INSERT / INSERT DE VIS	1
20	GLASS FASTENER / FIXATION DE VERRE	2
21	ROLLER / ROULETTE	2
22	ANTI-JUMP / ANTI-SAUT	2
23	RUNNING RAIL / BARRE DE ROULEMENT	1
24	STOPPER / BUTOIR	2
25	WALL BRACKET / SUPPORT MURAL	1
26	RETURN PANEL GLASS MOUNT BRACKET / SUPPORT DE VERRE POUR PANNEAU DE RETOUR	1
27	WALL PLUG / CHEVILLE	4
28	FLAT SELF-DRILLING SCREW #6 (1") / VIS PLAT AUTO-PERÇANTE # 6 (1")	1
29	FLAT HEAD SCREW #10 (2 ½") / VIS À TÊTE PLATE # 10 (2 ½")	4
30	PAN SELF-DRILLING SCREW # 8 (¾") / VIS PAN AUTO-PERÇANTE # 8 (¾")	3
31	SCREW CAP / CAPUCHON COUVRE-VIS	3
32	CLEAR SETTING BLOCK (5/32") / BLOC NIVEAU TRANSPARENT (5/32")	4
33	CLEAR SETTING BLOCK (1/8") / BLOC NIVEAU TRANSPARENT (1/8")	4
34	ANTI-JUMP SHIM / CALE POUR L'ANTI-SAUT	2