

**TOOLS REQUIRED / OUTILS REQUIS**

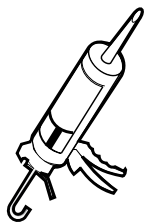

**SILICONE**  
**SCELLANT**

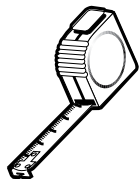

**TAPE MEASURE**  
**RUBAN À MESURER**



**PENCIL**  
**CRAYON**

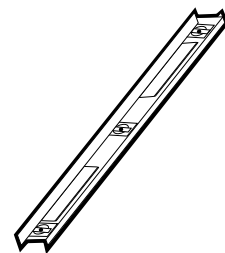

**LEVEL**  
**NIVEAU**

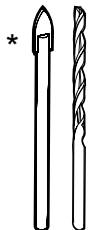

**1/4" DRILL BIT**  
**MÈCHE 1/4"**



**SCREWDRIVERS**  
**TOURNEVIS**

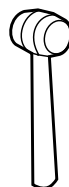

**MALLET**  
**MAILLET**

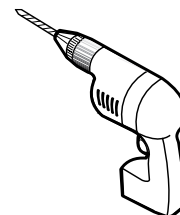

**DRILL**  
**PERCEUSE**

**\* Use a 1/4" drill bit when drilling into ceramic tiles**  
**\* Utiliser une mèche de 1/4" pour percer des tuiles en céramique.**

**POSSIBLE CONFIGURATIONS / CONFIGURATIONS POSSIBLES**

**\***

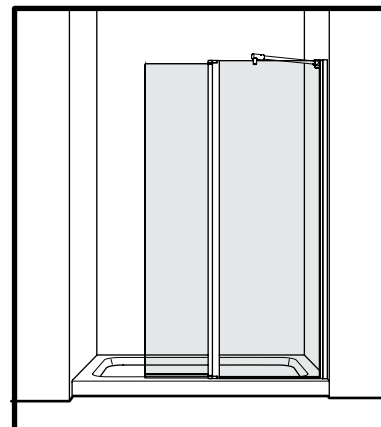
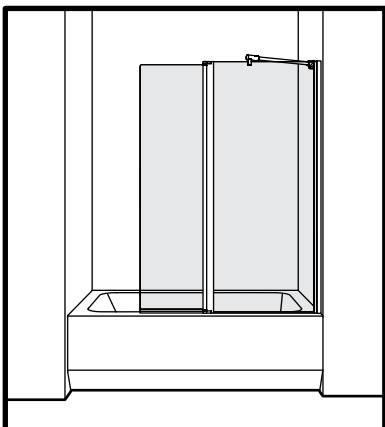
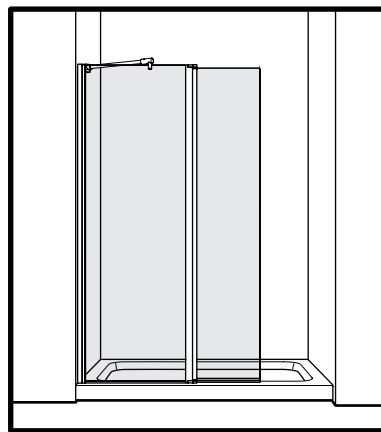
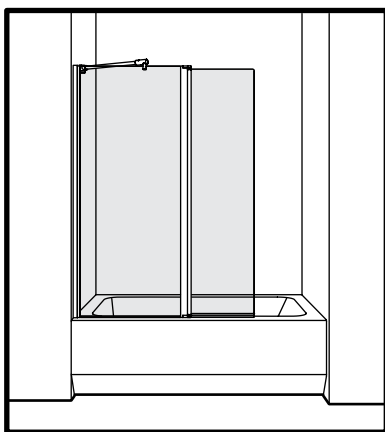

**\* This configuration illustrated in this manual.**  
**\* Cette configuration est illustrée dans ce manuel.**

PARTS LISTING / LISTE DES PIÈCES

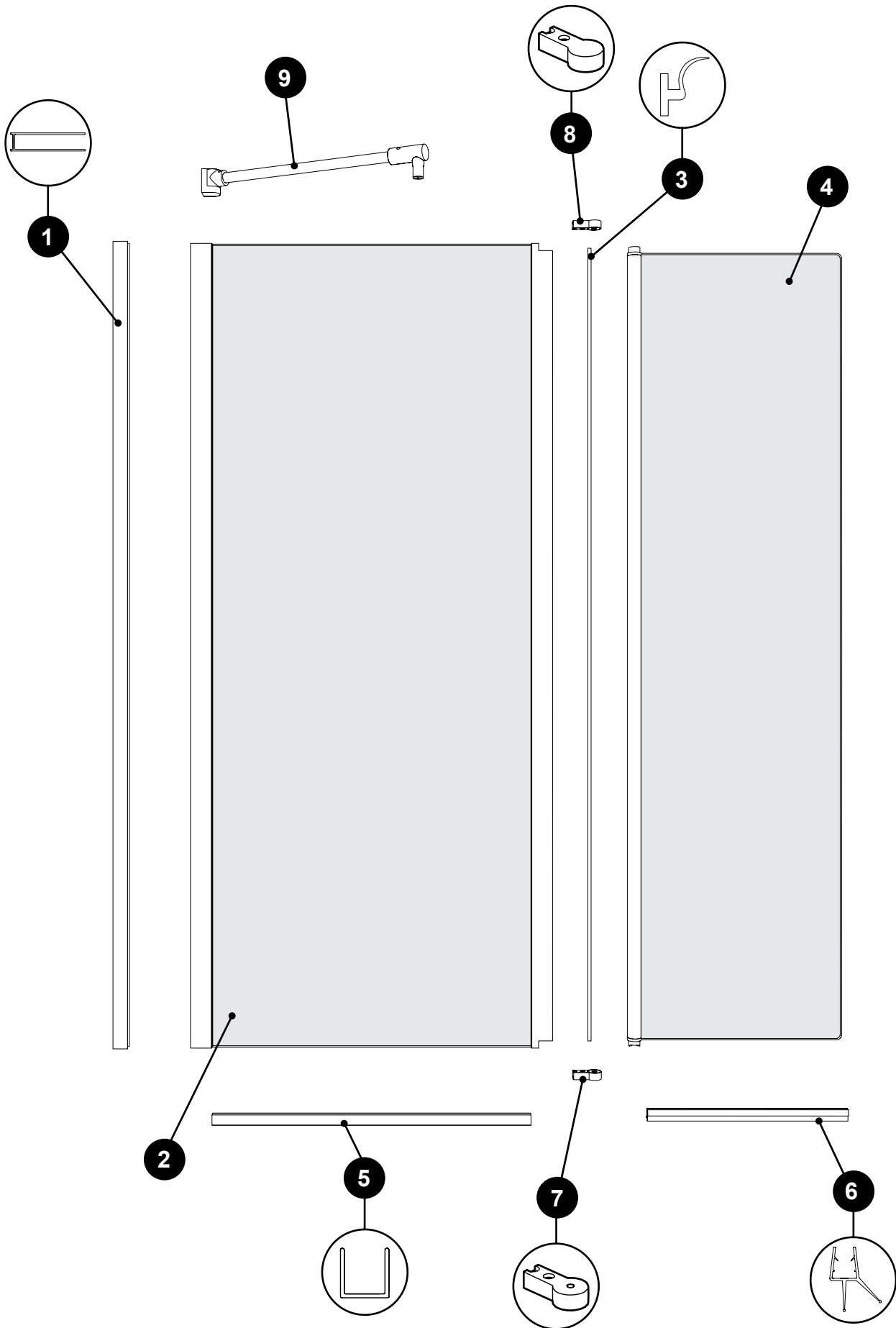

**PARTS LISTING / LISTE DES PIÈCES**

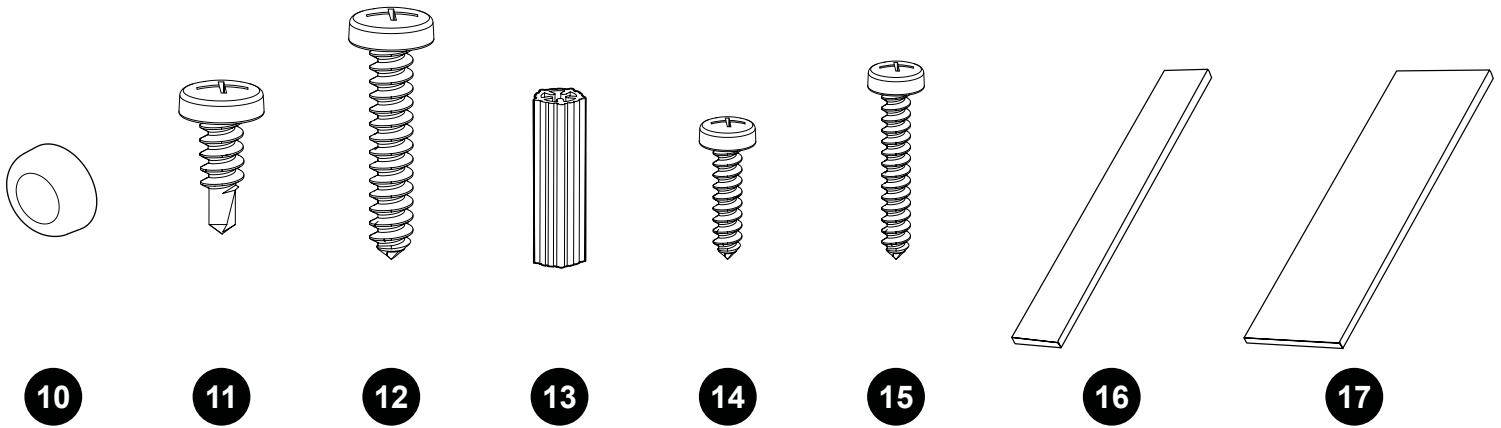

ITEM	PARTS AND HARDWARE / PIÈCES ET QUINCAILLERIE	QTY
1	WALL JAMB / JAMBAGE MURAL	1
2	FIXED PANEL / PANNEAU FIXE	1
3	FIXED PANEL GASKET / JOINT POUR PANNEAU FIXE	1
4	PIVOT PANEL / PANNEAU A PIVOT	1
5	U-CHANNEL / PROFILÉ EN «U»	1
6	BOTTOM GASKET / JOINT INFÉRIEUR	1
7	PIVOT CAP ANCHOR / CAPUCHON D'ANCRAGE POUR PIVOT	1
8	PIVOT CAP / CAPUCHON POUR PIVOT	1
9	SUPPORT BAR / BARRE DE SUPPORT	1
10	SCREW CAP / CAPUCHON COUVRE-VIS	3
11	SELF DRILLING SCREW 3/8" LG / VIS AUTO-PERÇANTE 3/8" LG	3
12	SCREW FOR WALL JAMB / VIS POUR JAMBAGE	3
13	WALL PLUG / CHEVILLE	4
14	SCREW FOR PIVOT ANCHOR / VIS POUR ANCRAGE A PIVOT	1
15	SCREW FOR FIXED PANEL / VIS POUR PANNEAU FIXE	4
16	CLEAR SETTING BLOCK (1/32") / BLOC NIVEAU TRANSPARENT (1/32")	2
17	SUPPORT BAR GASKET / JOINT BARRE DE SUPPORT	1