

**LISTE DES PIÈCES / PARTS LISTING**

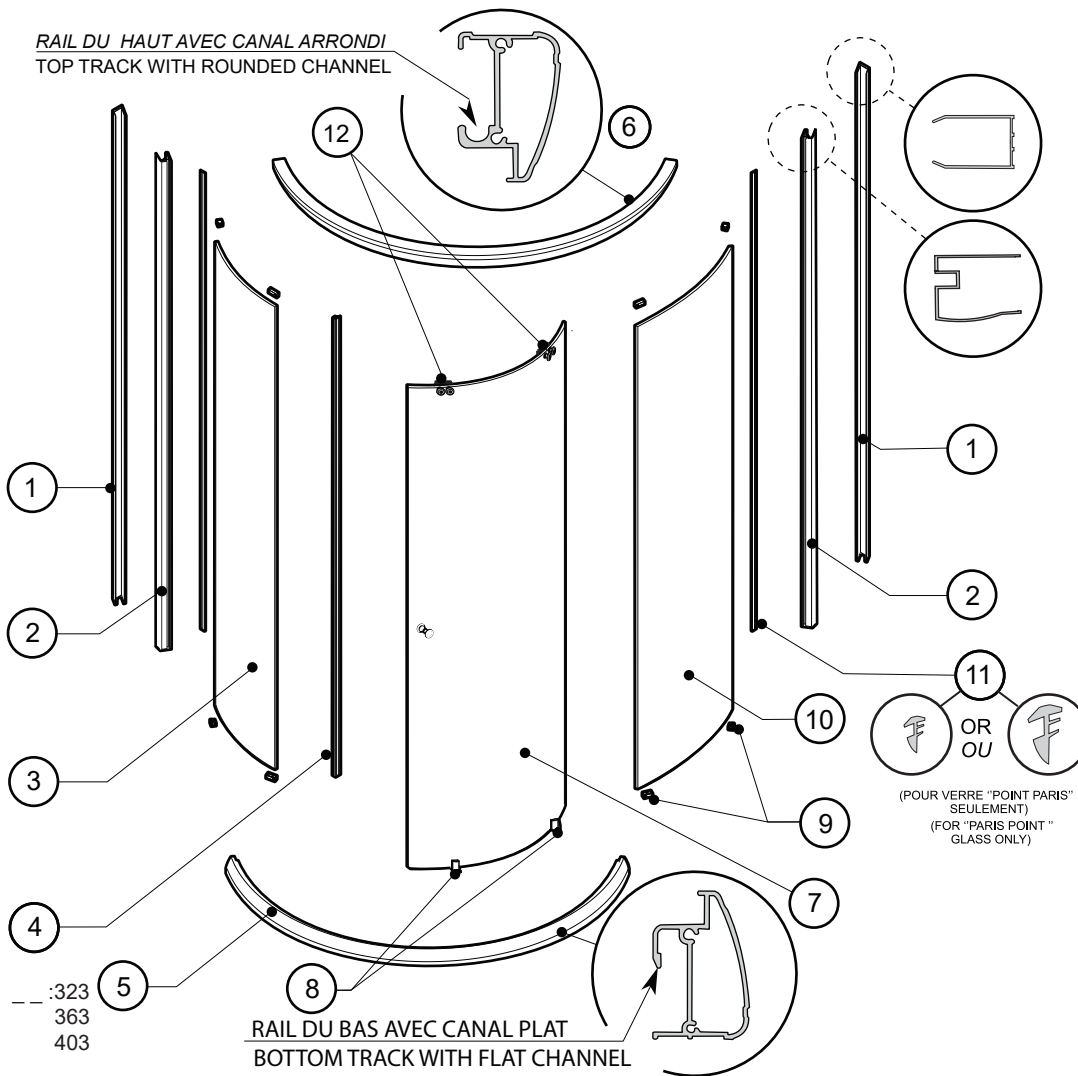

QUINCAILLERIE / HARDWARE

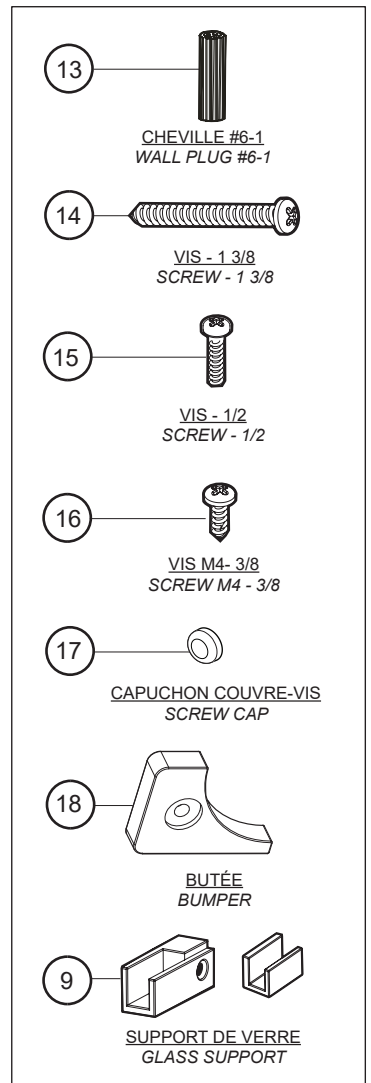

| ITEM | PART No.   | PIÈCES - PARTS  | QTY    |
|------|--|---|--------|
| 1    | EA-WJAMB-XX                                      | JAMBAGE - WALL JAMB                                     | 2      |
| 2    | EAL-EXPANDER-F-XX-75                             | PANNEAU FIXE AVEC EXTENSEUR - SIDE PANEL WITH EXPANDER  | 2      |
| 3    | EA-HANDLE-XX                                     | POIGNÉE - HANDLE  | 1      |
| 4    | COEX-FA120-74                                    | JOINT LATÉRAL DU PANNEAU FIXE - FIXED PANEL SIDE GASKET | 2      |
| 5-6  | EAX_XX-RAIL-XX                                   | RAIL SUPÉRIEUR ET INFÉRIEUR - TOP AND BOTTOM TRACK      | 1 SET  |
| 7    |  | PANNEAU DE PORTE - DOOR PANEL                           | 1      |
| 8    | EA-BTMGUIDE-XX                                   | GUIDE INFÉRIEUR - BOTTOM GUIDE                          | 4      |
| 9    | EA-CLIP-XX                                       | SUPPORT DE VERRE - GLASS SUPPORT                        | 4 SETS |
| 10   |  | GRAND PANNEAU FIXE - BIG FIXED PANEL                    | 1      |
| 11   | VINYL-EA-6(CLEAR GLASS), VINYL-EA-5(PARIS POINT) | JOINT LATÉRAL - SIDE GASKET                             | 2      |
| 12   | EA-TOPROLLER-XX                                  | ROULEAU SUPÉRIEUR - TOP ROLLER                          | 4      |
| ITEM |  | QUINCAILLERIE - HARDWARE                                | QTY    |
| 13   |  | CHEVILLE - WALL PLUG                                    | 8      |
| 14   |  | VIS 1 3/8" - SCREW 1 3/8"                               | 8      |
| 15   |  | VIS 1/2" - SCREW 1/2"                                   | 16     |
| 16   |  | VIS M4 3/8" - SCREW M4 3/8"                             | 8      |
| 17   |  | CAPUCHON COUVRE-VIS - SCREW CAP                         | 8      |
| 18   | EA-STOPPER                                       | BUTÉE - BUMPER  | 8      |